



PROVIDING SOLUTIONS FOR ALL YOUR TREE SURGERY, FENCING, VEGETATION MANAGEMENT AND WEED CONTROL REQUIREMENTS IN WILTSHIRE AND ACROSS THE SOUTH WEST

WHERE COMMON SENSE IS STILL COMMON

Tree Surveys with our own App developed with KaarbonTech



KaarbonTech
ASSET MANAGEMENT

We have developed an App with KaarbonTech which allows us to plot and report on individual trees directly onto a downloaded map from the registry. This gives us a much more professional and accurate report to BS standards to which our clients can have access. We're using a Samsung Tablet with GPS to download. So, if you need a precise report for insurance, tree reporting, surveys, Health & Safety or for any other reason, just call William on 07889 461 358 or email him on william@conservation-contractors.co.uk

As an example, this shows the plotting:

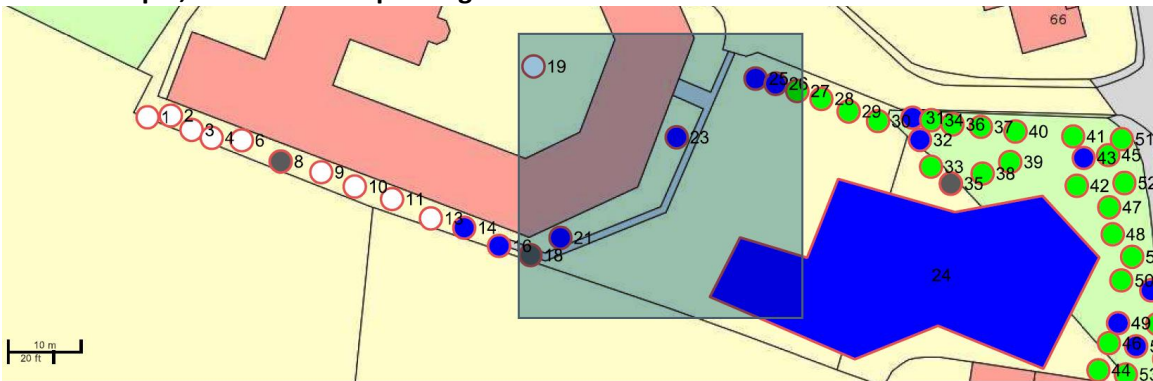

And this shows an example of the findings. You will see that where work is recommended, an estimate of time is automatically included.

No	Species	Height (m)	Age Class	Inspection Frequency	Work Priority	Est. Duration
4	Fraxinus excelsior (Common Ash)	7	SemiMature	FiveYearly	2	1hours
	GENERAL OBSERVATIONS Close to building, crown bias over building. PHYSICAL CONDITION Fair ; STRUCTURAL CONDITION Fair ; LIFE EXPECTANCY 10-19 years ;		PRELIMINARY RECOMMENDATIONS Preliminary recommendations: Reduce 1 m away from building			
5	Quercus petraea (Sessile Oak)	18	Mature	FiveYearly	0	
	GENERAL OBSERVATIONS Minor dead wood, no other defects PHYSICAL CONDITION Fair ; STRUCTURAL CONDITION Fair ; LIFE EXPECTANCY 20-40 years ;					
6	Betula pendula (Silver Birch)	7	SemiMature	FiveYearly	2	2hours
	GENERAL OBSERVATIONS Tree in decline ,major dead wood, poor pruning cuts, no value in retention may cause damage to building if to blow over. PHYSICAL CONDITION POOR ; STRUCTURAL CONDITION POOR ; LIFE EXPECTANCY <10 years ;		PRELIMINARY RECOMMENDATIONS Fell Tree			
7	Acer spp (Maple species)	7	EarlyMature	FiveYearly	0	N/A
	GENERAL OBSERVATIONS No major defects PHYSICAL CONDITION Good ; STRUCTURAL CONDITION Good ;					

Aviva have a useful insurance guideline entitled “**Liability for Hazardous Trees**”, the link to which may be found here. <http://www.aviva.co.uk/riskolutions/document-library/files/90/9001 - liability for hazardous trees.pdf>

www.conservation-contractors.co.uk

T 01380 726 739 M 07889 461 358 E info@conservation-contractors.co.uk

Conservation Contractors, End Farm, Marston, Devizes, Wiltshire SN10 5SR

